



641.774.7499

Monday-Thursday 9am-4pm CST

Email: sales@fatbaggers.com

These instructions describe the procedure to properly install 14-16" FBI EZ Install Handlebars for 2021-2023 Road Glide Models. You should review these instructions before installing the product as they contain important information regarding your FBI EZ Install Handlebars and Kit. Please keep instructions for future reference.

EZ Install Wired Handlebars 21-23 Road Glide Models

Items included in this kit:

- EZ Install Wired Handlebars
- These handlebars are pre-installed with a twist grip sensor, can bus wire harness for controls, and 1 pre-installed rope to accommodate heated grips.
- Clutch cable extension:
- 14" bars will include a 4" extension
- 16" bars will include a 6" extension
- Brake line extension
- Zip ties

Recommended Item sold separately: Clutch Adjustor Upgrade, Part Number 109811 for 2021 models, Part Number 109822 for 2022-2023 models.

WARNING: The rider's safety depends upon the correct installation of this kit. Use the appropriate service manual procedures. If the procedure is not within your capabilities or you do not have the correct tools, contact a dealer to perform the installation. Improper installation of this kit could result in death or serious injury.

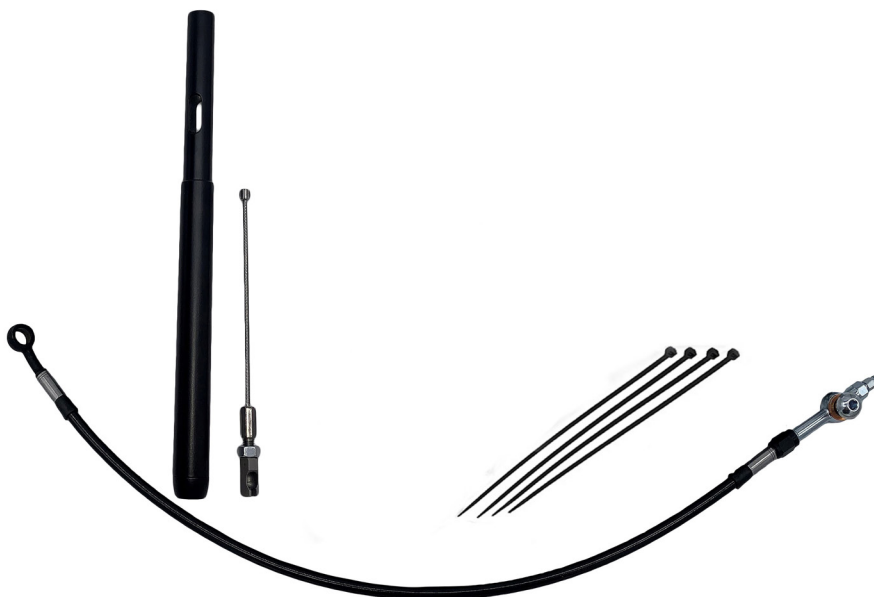

Tools & Supplies Needed

T25 Torx
T27 Torx
Small Pick
3/16 Allen
Side Cutters
12mm Wrench
1/4 Allen Socket
T40 Torx
Needle Nose Pliers
Tank and Front Fender Cover
Torque Wrench
7/16 Wrench
1/4 Wrench
3/8 Wrench

1. Install center handlebar bolt. Torque to 10 ft. lbs.

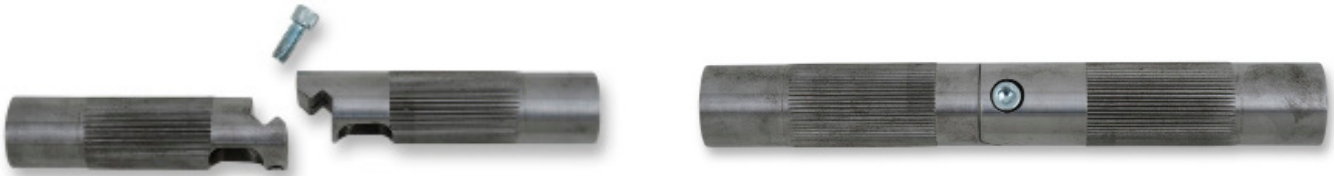

2. Cover fuel tank to protect from dropped parts and to prevent damage to paint.

3. Remove cover under ignition switch by pressing in on the back and pulling up. Be gentle-the small plastic tab breaks easily.

4. Remove gauge cluster by lifting straight up. Unplug the speedometer and two lower plug-ins.

5. Unplug 3 handlebar wires and throttle sensor wire.

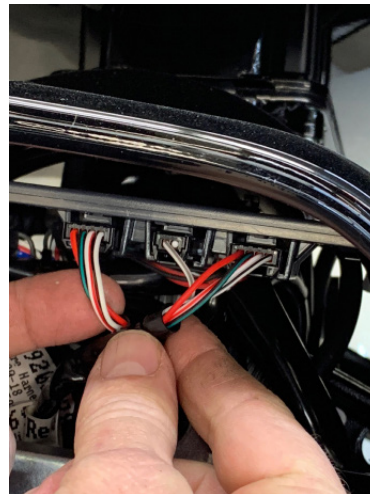

Handlebar Switch Wires

Throttle Sensor Wires

6. Remove plastic divider. It will not be reused.

7. Remove master cylinder clamps and master cylinders. Lay master cylinders on top of covered fuel tank.

8. Remove the handlebar clamps by removing the 4 bolts that hold it together.

9. Remove stock handlebars.



10 . Remove switch housings and switches from stock handlebars using small pick to release lock.

11. Remove grips from stock handlebars.

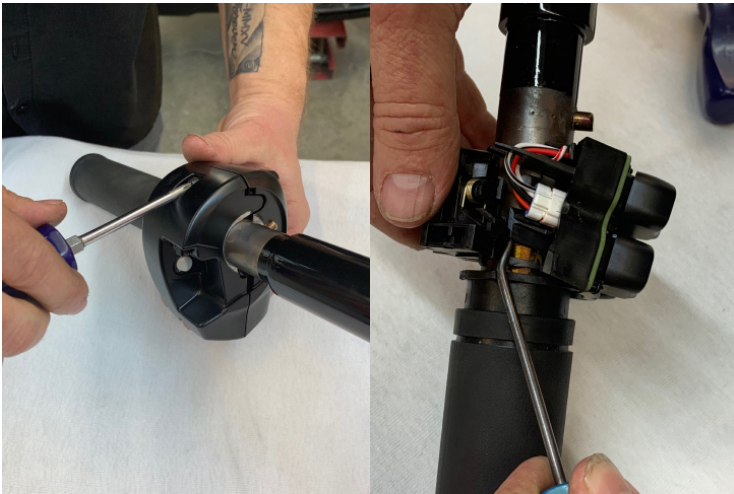

12. Use a hammer to tap the alignment pin down in bottom center of handlebar clamp. This pin is not needed with FBI's special knurling process which clamps handlebars tighter. Make sure the pin is below the clamp surface.

13. Install handlebars and handlebar clamp. Torque the 4 bolts that clamp the handlebars to 18-22 ft. lbs

14. If using internal wired heated grips, use the supplied rope in the left handlebar to pull the heated grip wires through the bars. If no internal wired heated grips are being used, remove the rope. Install switches, housings, and grips. Make sure the throttle grip turns freely.



15. Tuck stock line between fairing nacelle and top of triple tree.

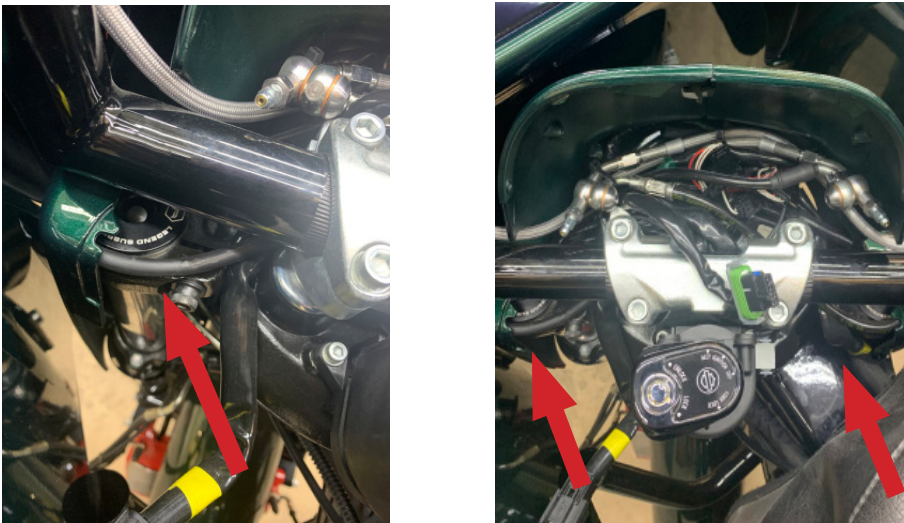

16. Install brake line extension as seen in photo. Secure with zip ties.



← Brakeline extension routing

17. Plug handlebar wires and throttle wire back in.



18. Bleeding process.

Items Needed: 1/4" Hose, Catch Cup, Brake Fluid

1. Open bleeder 1/4 turn and then install hose. Note: The bleeder valve provided is a speed bleeder. It has a spring and a ball inside of it. As you pump the levers, it allows fluid to pass out of the bleeder and reseals itself. No need for a vacuum bleeder.
2. Remove reservoir cap and position master cylinder in a downward position so air does not trap inside the reservoir.
3. Pump handlebar lever 8 to 10 times or until the lines are filled with fluid.
4. Re-tighten bleeder screw.
5. Apply brake/clutch and check for any leaks.
6. Reinstall gauge cluster.

19. Locate the clutch cable adjustor on the right side of the frame down tube.



20. Remove the cable clips from the frame. They will be reused.



21. Slide the adjuster tube up.



22. Use a straight screwdriver to remove the red clip. Then collapse the adjuster.



23. Rotate the yellow tube, and locate the little tab. Then separate it from the lower cable using the straight screwdriver.



24. Push the wire through from the backside using the screwdriver.



25. The cable is now split, as pictured.



26. Remove the yellow plastic piece by spreading open the two small tabs on each side.

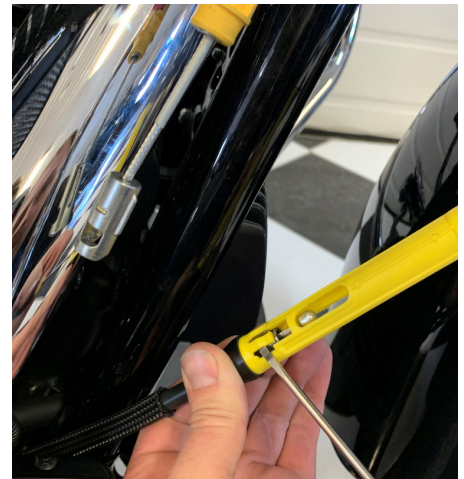

27. This yellow part will not be reused.



28. Remove the lower portion from the tube extension, and slide it over the stock cable.



29. Use the two wrenches to loosen the adjuster on the wire extension. Slip the wire extension over the wire, hand tighten the nuts, bring the adjuster nut down, then tighten with the wrenches.



30. Slide the tube extension over the wire.



31. Push the upper clutch cable up the frame, and re-install into the new clutch extension tube.



32. Connect the upper cable to the lower cable, through the oval opening in the black tube.



33. Now you can adjust the clutch cable and reinstall the black tube cover.



34. After you slide the cover back on, reinstall the frame clips.



35. After the bars are completely installed, check all functions of controls on the handlebars. Check for check engine lights. If check engine lights are on, refer to the owners manual on clearing any check engine light that may be on after changing handlebars. It is normal to have to reset these, and clear them.

36. After the handlebar installation is complete, follow this last step:

- **Set the right handlebar switch to run. Turn ignition switch to on. You will hear the fuel pump cycle on and off. Wait 30 seconds and turn ignition switch to off. Wait for the signals to flash for 30 seconds. Repeat this process 2 more times. This will reset the throttle body and make it in sync with the grip sensor. The bike is now ready to start.**