



These instructions describe how to properly install 14" and 16" FBI EZ Handlebars on 2018-2020 FLHRXS.

**809614**-14" FBI 1 ½" Pointed/Flat Top Handlebars with 1 ¼" Clamp for 18-20 FLHRXS  
**609614**-

**809616**-16" FBI 1 ½" Pointed/Flat Top Handlebars with 1 ¼" Clamp for 18-20 FLHRXS  
**609616**-

**109614**- Install kit for 14" and 16" Handlebars on 2018-2020 FLHRS

**WARNING:** The rider's safety depends upon the correct installation of this kit. Use the appropriate service manual procedures. If the procedure is not within your capabilities or you do not have the correct tools, contact a dealer to perform the installation. Improper installation of this kit could result in death or serious injury.

Test brakes at low speed. If brakes are not operating properly, testing at high speeds can cause loss of control, which could result in death or serious injury.



109614

1. Cover gas tank and front fender to prevent any damages.
2. Remove headlamp trim ring. Remove the 7 screws that hold head lamp.



3. Remove fork block cover by prying up on the pastic round cover.



4. Remove the pictured nut to take off nacelle trim.





5. Remove the 3 screws that hold down the handlebar clamp cover and remove.



6. Cut zip ties that hold brake and clutch lines on both sides.



7. Unplug both right hand switch housing plugs.



8. Unplug left hand switch housings and throttle sensor plugs and remove stock handlebars.



9. Install center handlebar bolt. Torque to 10 ft. lbs.

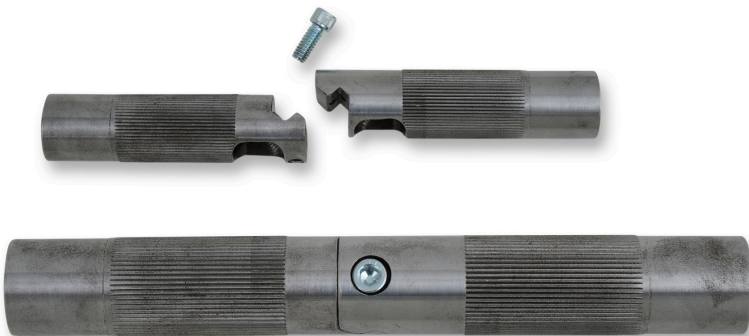

10. Prepare handlebars to install wiring and cables

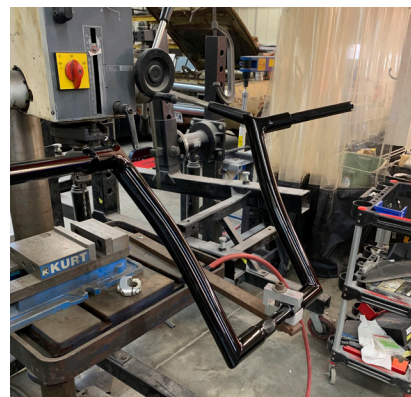



11. Using supplied ropes and air blower, push 2 ropes through the right FBI handlebar grip tube and bring through center clamp hole. Push 1 rope through left FBI handlebar grip tube and bring through center clamp hole.



12. Tape 1 string out of the right handlebar to the right grip tube and lower clamping area. This will be used later to run throttle wires through handlebar.



13. Installing the original handlebar control wires back into the bars. Start by taping the right control wire at the bottom side of the handlebar next to knurling. Pull right side rope up until wire comes out of grip tube. Then proceed with same procedure for left side.



14. Tape left handlebar wires to the string at the clamp area of the left handlebar. Lubricate taped area and pull wires up through handlebar.



15. Pull throttle wires through the right handlebars from the grip tube down through the hole in the clamp area as normal. Note: Make sure control wire is installed first.

16. Install wire extensions and turn signal wire extensions that are provided.

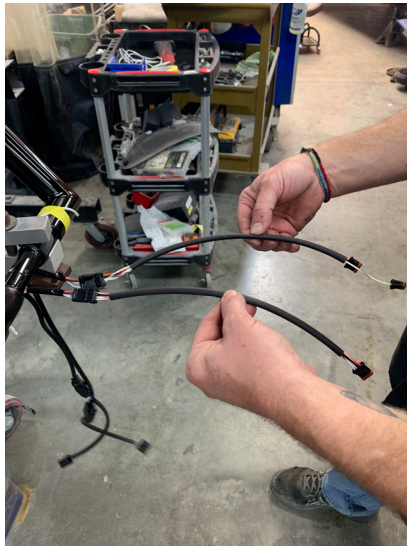

17. Reinstall switch housings and clamp the bars to motorcycle.

18. Remove clutch line from master cylinder and pull out through front of headlamp housing.



19. Remove bleeder fitting from the supplied line and route new line through headlamp housing. Then reattach bleeder fitting.



20. Attach stock clutch line to new bleeder fitting.



21. Pull brake line assembly into headlamp housing and attach to clutch master cylinder. Tighten all fittings.



22. Repeat this process with brake master cylinder and brake line extension.

23. Bleeding process.

Items Needed: 1/4" Hose, Catch Cup, Brake Fluid

1. Open bleeder 1/4 turn and then install hose. Note: The bleeder valve provided is a speed bleeder. It has a spring and a ball inside of it. As you pump the levers, it allows fluid to pass out of the bleeder and reseals itself. No need for a vacuum bleeder.

2. Remove reservoir cap and position master cylinder in a downward position so air does not trap inside the reservoir.

3. Pump handlebar lever 8 to 10 times or until the lines are filled with fluid.

4. Retighten bleeder screw.

5. Apply brake/clutch and check for any leaks.

24. Plug in harness extensions into stock location. Test function of switches and throttle. If working properly, reinstall headlamp and handlebar covers in reverse order.